

**ENVIRONMENT
HEALTH
SAFETY**



**CLEAN WORKSHOP
OIL SAVING
OVERHEAD COSTS REDUCTION**

GALILEO

Air filter for removing oil mist in the presence of heavy amount



MAXIMUM FILTRATION EFFICIENCY

Combining the benefits of a new design, the dynamic and static filtration and an exclusive drainage system.

NO VIBRATION

Special turbine studied not to withhold any particles on it, avoiding any possibility of vibration also with high presence of particulate.

QUICK MAINTENANCE

Maintenance operation completed in less than 5 minutes!

Just two pieces filters to be washed or replaced at occurrence and simply by opening the rear cover.

LONG LIFE OF FILTER MEDIA

Exclusive LOSMA drainage system guarantees higher drainage property, thus increasing the life of the filter media at the rear end.

COMPACT CONSTRUCTION

Compact design and construction of unit facilitates placement and installation easily over any type of machine, directly or on top of a stand.

BENEFITS

ENVIRONMENT

Eliminates the air pollutants associated with most of the production and metalworking applications.

HEALTH

Prevents skin and breathing disorders on your number one investment: the staff!

SAFETY

Safeguards from accidents caused by slippery surfaces and fire hazard risks due to dispersed oil mist.

CLEAN WORKSHOP

Improving working conditions, efficiency and company image.

OIL SAVING

Converts the mist into oil and send it back to machine for re-use, avoiding any dispersion into the workshop and atmosphere.

HOUSEKEEPING COSTS REDUCTION

No more oil mist deposits on floor, walls and machinery!

mist from workshop atmosphere, also with s of particulate.

WORKING PROCESS

The Galileo is equipped with a specially designed turbine that sucks in the oil mist and pollutants dispersed in the air from the working area. Due to the acceleration effect caused by the centrifugal force, the oil mist coalesces and converts to the liquid state. This oil in the liquid state is then sent back to the machine through the LOSMA drainage system for re-use. A filter fitted at the rear of the unit, blocks and captures the smallest pollutants, preventing contaminants to be released into the workshop atmosphere.

SUITABLE FOR

Machine Tools, Food processing machinery, Energy equipment, Chemical machinery, other Process Equipment.

SUPER-FILTRATION UNIT

The high level of filtration of the GALILEO series can be further expanded at any time into a super-filtration unit by adding a HEPA* post-filter, available in F9 or H13 level, respectively with 95% and 99.95%** efficiency.

* HEPA filter: High Efficiency Particulate Air Filter

** According to CE EN 778/1822 norms

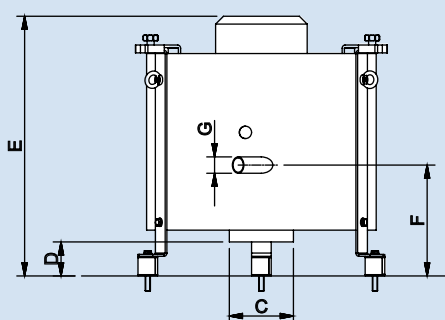
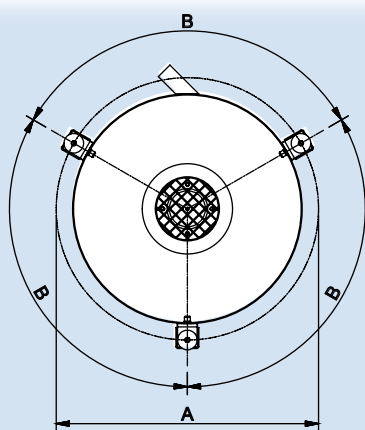

AIR FLOW - HEAD DIAGRAMS

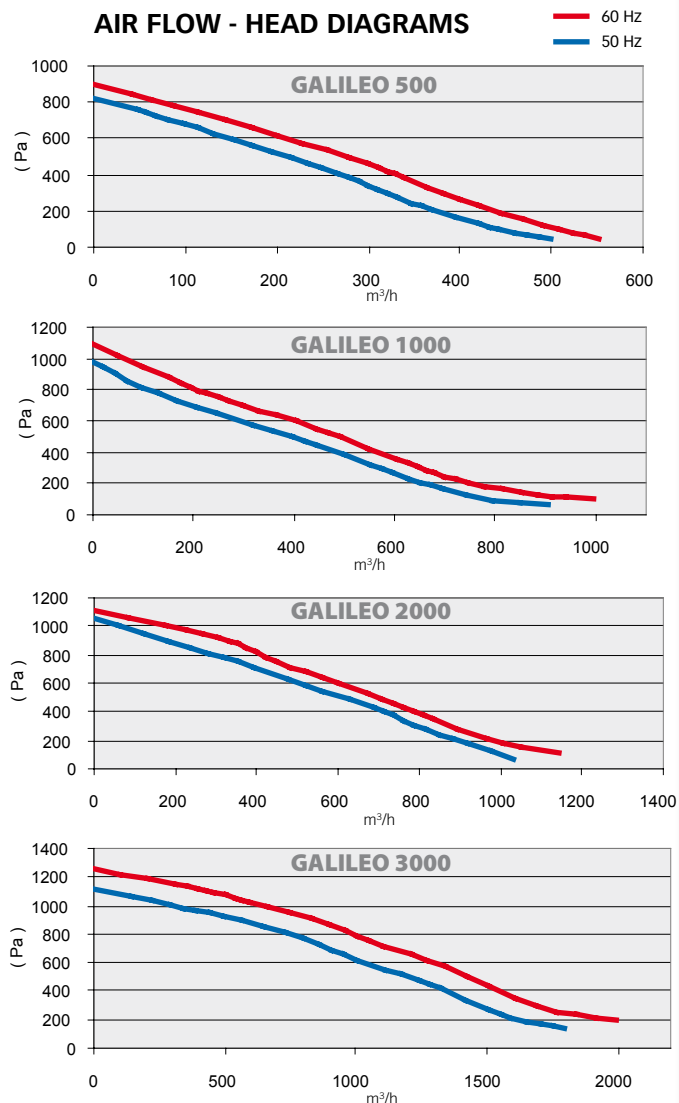

	GALILEO			
Dimension (mm)	500	1000	2000	3000
Ø A	400	490	490	560
B(°)	120	120	120	90(*)
Ø C	100	150	150	200
D	75	85	85	95
E	410	480	530	660
F	200	215	215	245
Ø G	25	25	25	25

(*) 4 fixing supports on G3000 model



TECHNICAL SPECIFICATIONS

MODEL	MAX FLOW RATE* (m³/h)		NOISE (dBa) 50 Hz	INLET Ø (mm)	RPM (n. rpm)		NET WEIGHT (kg)
	50 Hz	60 Hz			50 Hz	60 Hz	
G 500	600	650	68	100	2800	3360	14
G 1000	1000	1220	69	150	2800	3360	29
G 2000	2000	2250	70	150	2800	3360	34
G 3000	3000	3280	72	200	2800	3360	48

*Free inlet

ELECTRICAL FEATURES

ELECTRICAL MOTOR 3 PHASES, 2 POLES, PROTECTION INDEX IP55, F INSULATION CLASS				
POWER 50/60 Hz				
MODEL	POWER [Kw]	TENSION [V]	FREQUENCY [Hz]	CURRENT [A]
G 500	0.25 / 0.28	230	50	1,3
		400	50	0,75
		265	60	1,3
		460	60	0,75
G 1000	0.75 / 0.86	230	50	3,5
		400	50	2
		265	60	3,5
		460	60	2
G 2000	1.1 / 1.3	230	50	4,5
		400	50	2,6
		265	60	4,5
		460	60	2,6
G 3000	1.5 / 1.75	230	50	5,9
		400	50	3,4
		265	60	5,9
		460	60	3,4

Since 1974, LOSMA S.p.A. has been producing systems for treatment of air contaminated by oil mist, smoke and odour produced in workshop atmosphere and systems for the filtration of coolants used in machine tool applications.

With the widest product range available on the market, LOSMA has become the undisputed point of reference for customers all over the world.

The experience and know how of a highly qualified staff takes care of the design and engineering of the products, also for special developed solutions.

